



Amber Cove K715

Range Manufactured Homes



1547 sq.ft



3



3

Priced from

\$149,000.00

Jane & John Smith

412 N Stella Ave,
Lakeland FL 33801, USA

3 bedroom, 3 FULL baths in this beautiful open concept kitchen and living area with covered front porch. This plan has tons of optional design and layout configurations to make this perfect for any family that needs a bathroom for each bedroom!

- ✓ Dual-Glazed Vinyl Low-E
- ✓ Windows vertical Cement Fiber
- ✓ Siding hardwood Shaker Cabinets With Bank Of Drawers

Home Area

Kitchen	222 sq ft
Dining & living	299 sq ft
Master bedroom	260 sq ft



Candice Bernstein

Florida
candyb@canibuild.com
(689)-202-3169



Jack Jernstrom

California
jack.jernstrom@canibuild.com
(323)-403-4841

Location

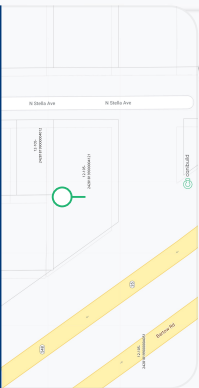

Site Calculations

SITE AREA	4259 sq ft
EXISTING FLOOR AREA	600 sq ft
PROPOSED FLOOR AREA	1547 sq ft
PROPOSED FLOOR SPACE RATIO	38.1%
PROPOSED SITE COVERAGE	47.1%

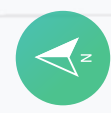
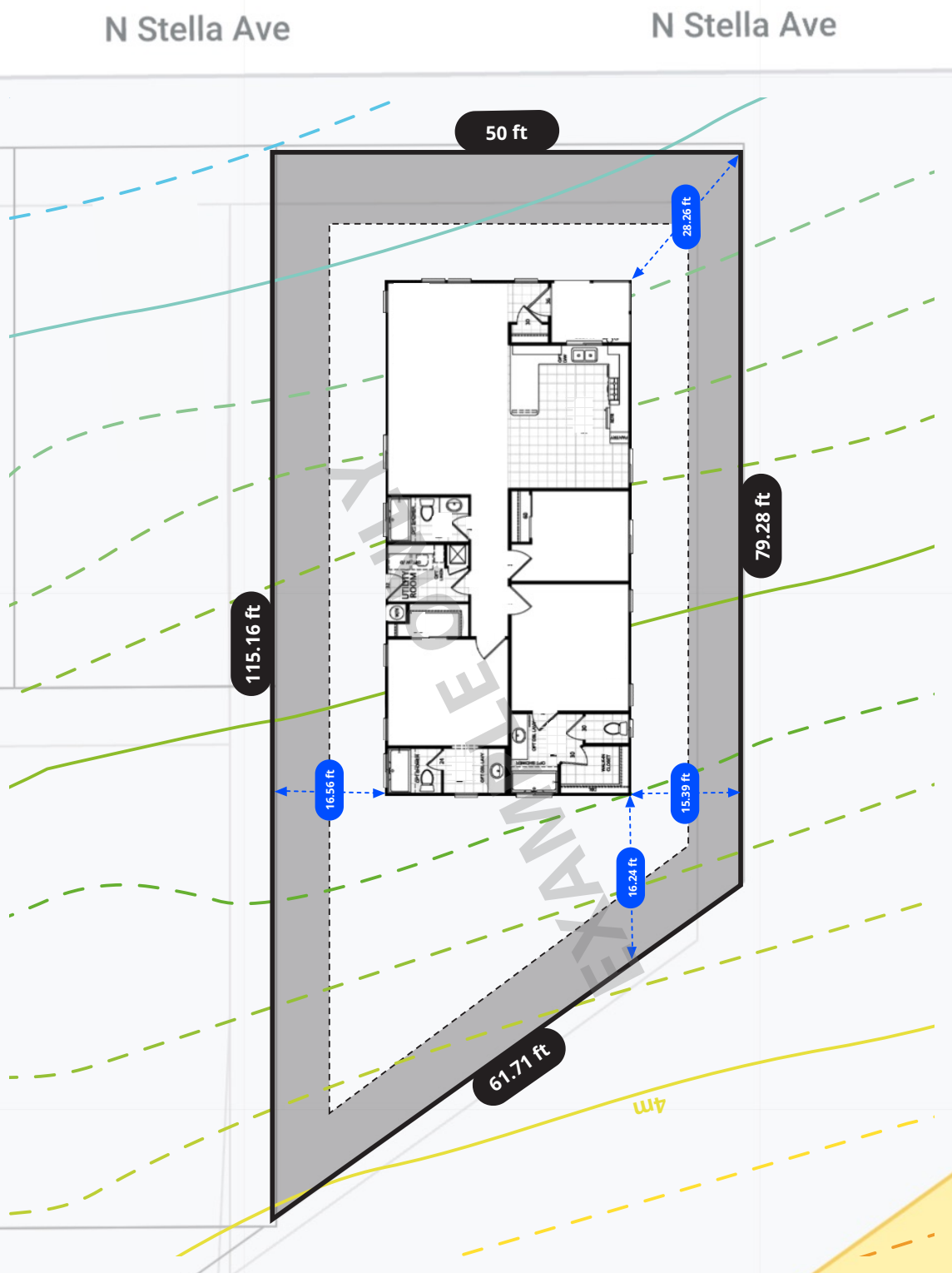

Disrupted by Cambuild.

Job no:	4651
Sheet name:	Site Plan
Design:	Amber Cover
Sheet no:	8
Date:	04.07.2021
Rev no:	1
Scale:	1:100

Client name:	Jane & John Smith
User:	R.D
Rev:	1
Description:	Modified/downloaded
Date:	04.02.2020
Property details:	412 N Stella Ave, Lakeland FL 33801, USA Polk County APN 12-105-2428181990000004121

Copyright Statement
This plan always remains the copyright of designer & shall not be used other than for the project work intended without written authority. No part may be produced by any other exclusive right be exercised without permission legal enforcement will be taken on copyright infringement.

Disclaimer
This is not an official document, and may not comply with current laws or industry standards. You should make your own enquiries and seek independent advice from relevant industry professionals before acting or relying on the contents of this document.





Entity Name Eco Home
License Number 31434c

Suite 44, 8-10 Tech Drive,
Lakeland FL 33801, USA
info@ecohome.com
900 000 009
www.ecohome.com

QUOTE 4651

Scope: Refer to site plan. Prepared by Candice Bernstein

DATE 09/07/2021

CUSTOMER John & Jane Smith
412 N Stella Ave,
Lakeland FL 33801, USA

040 011 2222
jsmith@gmail.com

JOB SITE 412 N Stella Ave,
Lakeland FL 33801, USA

DEPOSIT \$2,000.00

DUE BY 04/08/2021

BALANCE \$161,900.00

[Pay Now](#)

Manufactured Home

ITEM NAME	PRICE (ex tax)	QTY	UOM	AMOUNT (ex tax)
Amber Cove Model K715	\$149,000	1	Ea	\$149,000
<ul style="list-style-type: none"> Floorplan option 48 Made with recyclable materials 				
Subtotal:				\$149,000
Total:				\$149,000.00

List as many build details here as you like!

EXAMPLE ONLY

NOTES

Final finishes to be selected by client.

TERMS & CONDITIONS

Please click the following link to see all our Terms & Conditions which includes, denitions,conditions & qualifications as well as Exclusions. This affects your tender so its important thatyou read this. These Terms & Conditions will also form part of your building contract.

SUBTOTAL \$149,000

DISCOUNT \$0.00

TAX \$14,900.00

SHIPPING & HANDLING \$0.00

GRAND TOTAL \$163,900.00

DEPOSIT \$2,000

BALANCE \$161,900.00

Valid until 05/09/2021

SIGNED

	Candice Bernstein	08/07/2021	John Doe		08/07/2021
Sales Person	Signature	Date	Client Name	Signature	Date

Thank you!

Thank you once again for the opportunity to submit this quotation.

Please don't hesitate to contact us.





Hi John



412 N Stella Aven... Lot info

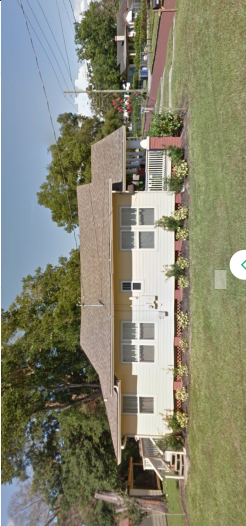

Jane & John Smith j.smith@gmail.com

Designs
 Rules
 Quote
 Cart
 Docs

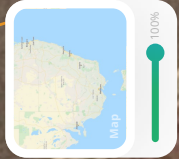

Site Details

APN	12-105-24281 81990000041421
Legal description	TRACT # 6098 LOT 88
Owner names	JANE SMITH; JOHN SMITH
County	POLK
Corner Block	Yes
Land zoning	L1
City	LAKELAND
Lot size ac/sq ft	0.11 / 4,861.15

